

made of grade 304 stainless steel - grade 316 on request

Folded edges with flange waterproof membrane application.

### Dwg. 0926: CHANNEL WITH GRATING

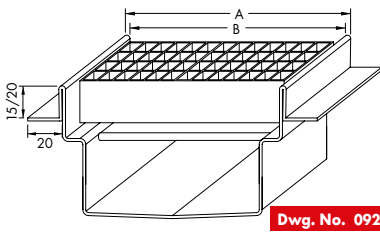

Dwg. No. 0926

21	Article	A (Overall dim.)
	CGS 0926	Variable

Folded edges with flange suitable for channels at page 16

### Dwg. 2026: CENTRAL SLOT WITH VERTICAL EDGES

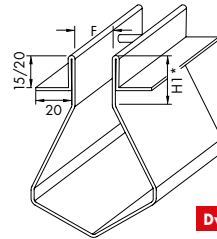

Dwg. No. 2026

\*Dimension H1 = 30 mm minimum

24	Article	F (Slot)
	C1BDV 2026	8 mm slot
	C2BDV 2026	20 mm slot

Folded edges with flange suitable for channels at page 13

### Dwg. 2015: CENTRAL SLOT WITH VERTICAL EDGES-FLAT UPPER SURFACE

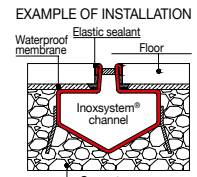
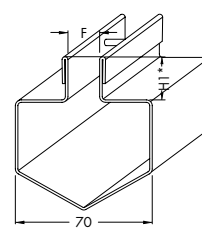

Dwg. No. 2015

\*Dimension H1 = 15 mm minimum

MINIMUM STARTING DEPTH = H1 + 40 mm

14	Article	F (Slot)
	C1BDV PM	8 mm slot
	C2BDV PM	20 mm slot

### Dwg. 5026: Inoxsystem® Total Hygienic CHANNEL

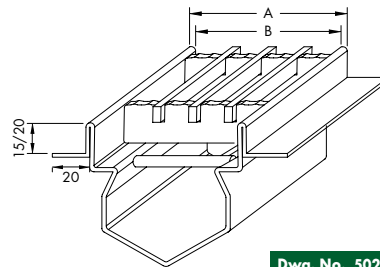

Dwg. No. 5026

22	Article	A	B
	TH 80 BPGPS	78	67

\*For more information see page 49

### Dwg. 2027: LATERAL SLOT WITH VERTICAL EDGES

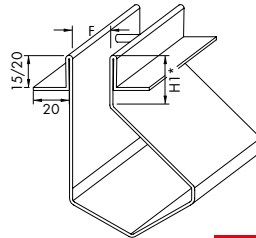

Dwg. No. 2027

\*Dimension H1 = 30 mm minimum

25	Article	F (Slot)
	C1BDVL 2027	8 mm slot
	C2BDVL 2027	20 mm slot

Folded edges with flange suitable for channels at page 13

### Dwg. 2016: OFFSET SLOT WITH VERTICAL EDGES-FLAT UPPER SURFACE

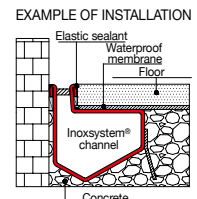
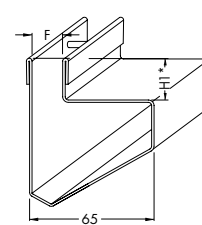

Dwg. No. 2016

\*Dimension H1 = 15 mm minimum

MINIMUM STARTING DEPTH = H1 + 50 mm

15	Article	F (Slot)
	C1BDVL PM	8 mm slot
	C2BDVL PM	20 mm slot

## Inoxsystem® Italia IDrain LINEAR SHOWER DRAINS

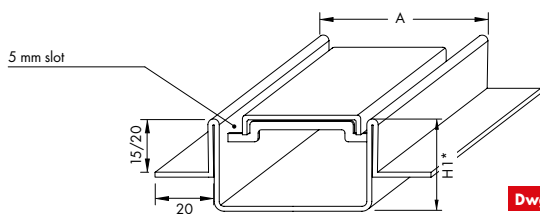

Dwg. No. 3026

\*Dimension H1 = 35 mm minimum

27a	Article	A (Overall dim.)	H1 max
	ID60 BPGPS	60	45 mm
	ID90 BPGPS	90	75 mm

Folded edges with flange suitable for Inoxsystem® Italia IDrain linear shower drains

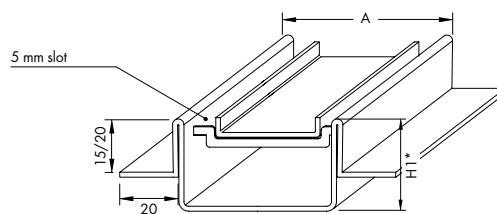

Dwg. No. 3027

\*Dimension H1 = 35 mm minimum

27b	Article	A (Esterno)	A (Overall dim.)
	ID60P BPGPS	60	45 mm
	ID90P BPGPS	90	75 mm

\*With tileable cover

Folded edges with flange suitable for Inoxsystem® Italia IDrain channels

## INSTALLATION EXAMPLES



- 21 Channel with grating with folded edges and flange for connection of waterproof membrane
- 22 Inoxsystem® Total Hygienic channel with grating with folded edges and flange for connection of waterproof membrane
- 23 Channel with central slot and folded edges with flange for connection of waterproof membrane
- 24 Channel with lateral slot and folded edges with flange for connection of waterproof membrane
- 14 Slot channel with central slot and vertical edges, with flat upper surface for waterproof membrane application
- 15 Slot channel with lateral slot and vertical edges, with flat upper surface for waterproof membrane application
- 27a Inoxsystem® Italia IDrain linear shower drain with satin finished cover and folded edges with flange for connection of waterproof membrane
- 27b Inoxsystem® Italia IDrain linear shower drain with tileable cover and folded edges with flange for connection of waterproof membrane